

# Newsletter

Thursday 17th December 2020

## Headteacher's Message

Dear Parents and Carers,

Before we end the term to celebrate Christmas, we would like to thank staff, students, parents and governors for their unwavering support during this uniquely challenging term. As can often be the case, our community has pulled together, galvanized and strengthened even further in response to the unprecedented challenges faced this term.

In this final newsletter of the term, we draw your attention to some key messages from the college, from Liverpool City Council and to some of the recorded festivities and celebration events we have enjoyed during this Christmas period.

### COVID safety during the holiday and on return

Liverpool City Council have written to thank schools, parents and students involved in the recent mass testing project. The city's commitment to this scheme has undoubtedly secured some of the small liberties we have all been afforded over this Christmas holiday. The City Council and the college are keen to stress the continued importance of social distancing, hand hygiene and face coverings to help stem the spread of virus, thus giving time for the vaccination programme to take effect.

### Reporting positive COVID cases during the holiday

We have also re-issued the details of how parents are to report positive COVID cases to college during the holiday using our admin email address ([ao@notredame.liverpool.sch.uk](mailto:ao@notredame.liverpool.sch.uk)). This will help the college support the national track and trace process by notifying families of any close contacts.

### Student Progress Reports to parents

We can also confirm that student progress reports have been sent out via post this week. Given the seasonal strain on Royal Mail and subsequent delays, we apologise for any potential inconvenience caused by this. Please look out for these in your post during the holiday and do not hesitate to contact college reception on our return if you do not receive your son or daughter's report for any reason.



## INSIDE THIS ISSUE

GCSE After school revision	3
Class Charts.....	4
The Pantry .....	5
Online Learning .....	6/13
Attendance .....	14
Theme of the Week	15
Reflection .....	16

### Christmas Festivities

And finally, we wanted to take one more opportunity to share with all Notre Dame families and friends, links to our numerous Christmas celebrations and festivities. Many thanks to every student and member of staff involved in keeping these traditions alive under such challenging circumstances. The Christmas messages of Joy, Hope, Love and Peace have never felt more apt or needed. We hope you enjoy watching these celebrations as much as we enjoyed creating them.

Wishing all Notre Dame families and friends a peaceful and holy Christmas filled with the joy of the coming of Jesus Christ.

Mr Duffy



### COVID Confirmed Cases over Christmas

After school breaks up for Christmas we all still have an important job to ensure that any contacts of a confirmed case are identified and given details of isolation. This will help to keep the virus under control and protect family members and friends over the Christmas period.

The school will continue to monitor our email address [ao@notredame.liverpool.sch.uk](mailto:ao@notredame.liverpool.sch.uk) until 20<sup>th</sup> December 2020.

We ask parents to inform school if their child:

- develops Covid-19 symptoms (new persistent cough/high temperature/loss of taste or smell)
- has taken a test and is waiting for results
- has tested positive

Please do not delay in informing school. This will allow school to work with families to contact trace where necessary leading up to Christmas. If your child develops symptoms or takes a test in which they are positive **after 20<sup>th</sup> December**, they do not need to inform school.





16<sup>th</sup> December 2020

Dear Parents and Carers,

We would like to thank you for your continued support in the fight against Coronavirus.

Although the number of infections in Liverpool has reduced, the rate of reduction has levelled out and infections in working age and older people are still too high. We therefore all need to continue to be careful and stay safe.

Although the number of infections in Liverpool has reduced, the rate of reduction has levelled out and infections in working age and older people are still too high. There are key actions we urge you take to stay safe and keep infections low around socialising over Christmas and returning to school.

### Holiday socialising

Just because we can mix outside of our household over 5 days over Christmas – doesn't mean we should. We urge you consider just how much mixing you will need to do and how you can continue to reduce the risks, as some people such as the elderly and those with underlying medical conditions continue to be at much greater risk. Over Christmas we ask that you please:

- Stick to your bubbles
- Minimise contact with individuals who are unwell by ensuring that those who have coronavirus (COVID-19) symptoms, or who have someone in their household who does, stay in isolation.
- Avoid large gatherings
- Avoid unnecessary contact
- Open a window for ventilation
- Continue to wash your hands thoroughly and more often
- Continue with good respiratory hygiene: use a tissue and catch it, bin it kill it. Remember there are other infections doing the rounds over the winter period including influenza (flu). Please ensure you have your flu vaccination if you are in a vulnerable group.

Christmas advice (from .gov.) <https://www.gov.uk/guidance/guidance-for-the-christmas-period>  
Please follow the local rules on where you can go and who you can meet, including on New Year's Eve when your Christmas bubble will no longer apply.

### Children returning to school

To prevent the virus coming back into the school in the new school term **we urge all secondary school and college pupils take a Lateral Flow Test** once you and they have finished your main Christmas socialising but before returning to school. Asymptomatic testing is available to all school children.

There are still a number of test centres open over the Christmas Period and into the New Year. Full details can be found below:

<https://liverpool.gov.uk/smarttesting>

We would like to thank you again and wish you a Merry Christmas and well-deserved restful break.

Yours Sincerely,

*Matt Ashton*

Director of Public Health, Liverpool

*Steve Reddy*

Director of Children's Services, Liverpool City Council

# "THE PANTRY" @ NOTRE DAME



Notre Dame  
Catholic College

Established 1869

180 Great Homer Street, Liverpool L5 5AF  
Tel: 0151 330 5122 Fax: 0151 207 0904  
Email: [ao@notredame.liverpool.sch.uk](mailto:ao@notredame.liverpool.sch.uk)  
[www.notredameliverpool.com](http://www.notredameliverpool.com)

Headteacher: Mr Peter Duffy BA(Hons) NPQH

Our Ref: RW/Admin/4

20<sup>th</sup> October 2020

Dear Parent or Carer,

## The Pantry at Notre Dame

We realise in these difficulty and very different times that there may be some families who need that little extra support. As a community, Notre Dame would like to offer the service of "The Pantry" to all of our families as we support each other.

The Pantry is a confidential service (foodbank) run by Notre Dame, whereby you can contact Rebecca Wall, our Chaplain, and ask for help with items of shopping, food and toiletries, that you are unable to afford at the moment during these unprecedented times. It may be that you are unable to access benefits, have been made redundant, are working less hours – all making it difficult to feed/support your family as you would normally do.

You may only need to use The Pantry once, or you may need to use it on a more regular basis. Please feel free to call Rebecca and speak to her directly in confidence. You don't even need to share information with your child.

If you would like to discuss this further or have any questions, please do not hesitate to contact me either by telephone or email ([rwall18.341@notredame.liverpool.sch.uk](mailto:rwall18.341@notredame.liverpool.sch.uk)).

*Remember you are not on your own in this – we are all in it together !*

Kind regards

Miss R Wall  
School Chaplain



# ATTENDANCE

ATTENDANCE  
2020-2021



Winning Form  
Classes

Year 7: 7D

Year 8: 8J

YEAR  
9  
WINNERS!!

Year 9: 9F

Year 10: 10J

Year 11: 11F

Week commencing 14<sup>th</sup> December 2020





# Notre Dame Catholic College SEND Newsletter

Academic Year 2020/21 Issue 2

'Do small things with great love'

## Reflection

I just wanted to pause at the end of this first term in school, my first complete one here at Notre Dame. This is a journey for me and something that I am proud to say that I am part of and something I am proud to lead on. When I say lead, it sounds like it is me, but it is not, we are a team here at Notre Dame and without the SEND team here, nothing would be possible, thank you. They have driven the ideas that we have developed, taken them on board, overcome the challenges and are still here, wanting to make things even better for the pupils.

For me, the key achievements are below;

## The Base

We launched our Base Room, where pupils can go for interventions, to calm down or even to just pop in to see our team. It is a warm and welcoming room and one we will develop even further as time goes on.

## Links with Primary Schools

This is a massive project and we have so far been working with two primary school and will continue to do more. I want to thank the leadership teams at Faith Primary School and Whitefield Primary School. We are excited about the future and for our transition plans.

## Parent/Carers Coffee Morning

We had our first ever coffee morning, albeit virtually. I talk about this more in this issue and invite more parents/carers to the next one.

## Our Sensory Room

This is a massive project and I will talk more about this on the next page, but it is exciting and will be in place in early 2021.

## Thinking about meaningful Assessment

One of our biggest moves was around assessment and it being meaningful for all of our pupils. We have been trialling the Evidence for Learning App and it has been life changing for me and the team. We have been able to capture subtle progress points through videos and photographs and we look to expand this across the school next term.

This is only a snapshot of what we have done, but there is so much more to follow. Have a great break and restful time heading into 2021.

## First Virtual Coffee morning for Parents and Carers

This half term we held our first ever virtual coffee morning for parents and carers. We were joined by LivPaC and the Isabella Trust who were able to share the work that they do for families and the support that is available outside of school. We want to work together with these groups to bring about change and also to work in a united way to support our pupils and their families. It was great to be joined by some parents who have only recently gone through the assessment process and could share their personal views. Thank you so much for being open, honest and engaging, it was a great session and I hope more of you can join us at the next one.



## Evidence for Learning



This half term we have been trialling a new way to gather assessments for our pupils and this includes our interventions and our pupils who have an EHCP. This is a massive shift and is providing us with more on the ground and subtle evidence to support our SEND pupils, but also those pupils who find assessments difficult. We will be developing this further as the year progresses, but if your child has an EHCP, we will be in contact in the New Year to begin the review process for all EHCP's. Look out for a letter from us in early 2021.

## The Notre Dame Sensory Room Project

This has been a massive project and something that we have quietly been working on in the background, but it would not have been possible with the support of **Ian Byrne MP**, **The Spirit of Shankly** and **The Fans Supporting Foodbanks**. I met with representatives of the groups earlier on in the year and shared my vision for a multi immersive sensory room to support our pupils. They picked this up straight away and saw the positive impact that this could have on our pupils and the wider community and supported us in a way that was beyond what we expected. They have part funded this room within the school and things are moving forward so quickly. It should be in place and supporting our pupils in early 2021.

I want to take this opportunity to publically thank these groups and those members within them that have liaised with me, met me over Zoom and agreed to release the funds to get this project off the ground. You honestly do not know the impact that you will have on our pupils, so thank you.



Below are the plans for the room and I cannot wait for work to begin next year.

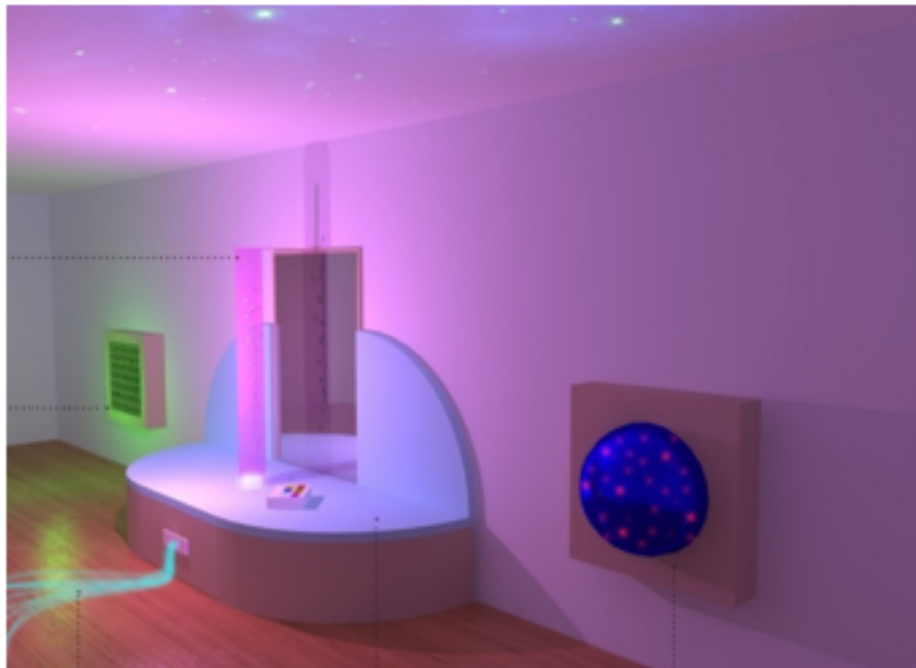



## MYon Reader and TTRockstars

All of our pupils in years 7 to 11 have been given access to an extensive range of interventions and programmes in school and these can be accessed at home and we would like this to be done throughout the week. The programmes are online and support the pupils with their literacy and numeracy development.



The first programme is called myON and this is a reading programme that can be accessed through the following website - <https://www.myon.co.uk/login/>. Your child will have a set of books that match their reading age and ability and this has already been set through our online programme in school.

You will need to choose our school in the first box and it is the only Notre Dame school to appear. The username and password will then need to be entered, these are included at the bottom of this letter.

Every pupil's username and password are set as their username to log into the school system, so for example;

**Username:** mcvea011.341

**Password:** mcvea011.341

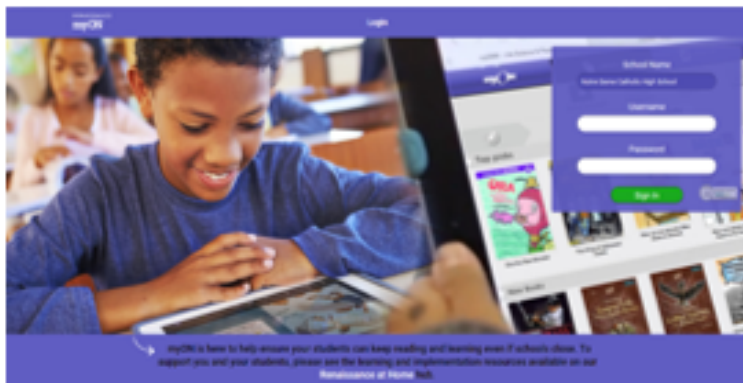

Our second programme is called TT Rockstars and this is a math's programme that improves the pupil's multiplication and division skills. This site can be accessed through the following website - <https://play.ttrockstars.com/auth/school/student>. Your child is assigned specific timetables to work on and this is set by the class teacher.

We ask that this programme is accessed three times per week and for a minimum of 20 minutes per session. We will be tracking usage and progress in school and we are really pushing this as it is important for their development.

Every pupil's username and password are set as their username to log into the school system, so for example;

**Username:** mcvea011.341

**Password:** mcvea011.341



## Intervention Focus

### Numeracy

#### Numicon – Breaking Barriers

Numicon is a set of resources that further supports pupil's mathematical knowledge and understanding in a visual and recognisable way. It is used to support those pupils who are still working within the Key Stage 1 and Key Stage 2 curriculum areas. This year we have bought the Breaking Barriers Teaching Handbooks and also the Apparatus set. These are used in conjunction with each other and they are used within classroom lessons (smaller groups), but also in 1:1 and small group interventions.

Numicon is a tool that we use alongside our daily practice and supports the pupils with tactile and kinaesthetic approaches to learning, but also supports those pupils who have other additional needs, such as SpLD, dyslexia and dyscalculia.

More information can be found here [Breaking Barriers](#)



### Literacy

#### Word Wasp

The Word Wasp, like the Hornet Literacy Primer, is a manual for teaching literacy skills: both reading and spelling. It too can be used by anyone. In short: you do not need to be a teacher or a professional: A coach needs a moderate ability to read the English language. The structured programme is based on phonics and those rules which govern English. Our texts rely on teaching the 43 sounds/rules that form the structure of our language. The Wasp does not rely on memory! We start with the basic letter sounds and work our way through the language. Coaches are guided throughout the Wasp with easy to follow instructions and the simple marking system directs coaches to problem areas.

The Word Wasp like the Hornet has been designed in order that students will not be confronted by anything beyond their grasp and it has also been designed to reflect its efficiency. Patronizing graphics and language will not be found amongst the exercises. No one will find the text embarrassing, which makes them ideal for both young and older students.

The Word Wasp is a comprehensive programme beginning with basic letter sounds before progressing to more complex diphthongs and digraphs. It can be used with students from the age of seven to adult. The programme ends with polysyllabic words of Latin and Greek origin.

#### **Reading and Spelling Problems solved through Rules and Structure**

Both Wasp and Hornet programmes start from the premise that no one learns to read or spell by remembering the shape or letter order of a word. Our language and every other language is a code. **Fail to teach the code! Fail to teach the student!** Both the Word Wasp and the Hornet have been carefully designed so students are reintroduced to rules on a regular basis in the reading and spelling exercises. When rules reappear, coaches are invited to reintroduce them by demonstrating them on scrap paper. Students can then be directed to the cause of a spelling mistake and the rules will be re-enforced once more. We are teaching the code of the English language! We are not teaching our students to memorise words. Giving students word lists is the equivalent of giving a word a number. **How many telephone numbers can you remember?** Simplicity is the key to both programmes

A coach does not need I.T. skills: complimentary literature, books, audio tapes or video tapes.

Information taken directly from <https://www.wordwasp.com/the-books/the-word-wasp/>



## Kooth

Kooth is a free and anonymous service for young people aged 11 to 18. This time has been uncertain and stressful and sometimes children are not able to talk to those closest to them for fear of upsetting them or even not knowing how to talk about their emotions and anxieties.

Here children have the opportunity to talk to someone who they do not know through a live chat. It is a great resource and it is free. It is good to talk and it is important to talk about our mental health.

You can access the website through the following link <https://www.kooth.com/>



## Safeguarding Team Information

We are always here for you if you need any help or support and we have a dedicated safeguarding team who are available throughout the school week, please contact the team using the details below.

Email: [sg@notredame.liverpool.sch.uk](mailto:sg@notredame.liverpool.sch.uk)

Phone: 0151 330 5122

<https://www.notredameliverpool.com/safeguarding>



## Notre Dame SEND Padlet

As we have discussed in the past, we have developed our own Padlet site which contains all of our SEND and support materials. As mentioned, you can download the app or you can simply access it through your web browser on a computer, tablet or phone.

[https://padlet.com/anthony\\_mcverry/41a0j37vi8nsqxcx](https://padlet.com/anthony_mcverry/41a0j37vi8nsqxcx)



Follow our SEN advice and guidance through our SENCO on twitter

@NotreDameSENDSCO



## Liverpool's Local Offer

